

MOSELEY ARCHITECTS

A PROFESSIONAL CORPORATION

Fee Proposal Breakdown for

Reidsville High School - Machining Lab/Locker Room Renovation

October 12, 2018

	Hourly Rate	Manhours	Cost
Architectural			
	\$213.00	X 6	hrs = \$1,278.00
	\$141.00	X 80	hrs = \$11,280.00
	\$93.00	X 30	hrs = \$2,790.00
	Subtotal =	116	hrs = \$15,348.00
Structural	\$123.00	X 12	hrs = \$1,476.00
Mechanical	\$134.00	X 60	hrs = \$8,040.00
Electrical	\$134.00	X 40	hrs = \$5,360.00
Construction Administration	\$141.00	X 16	hrs = \$2,256.00
			\$30,224.00

MOSELEYARCHITECTS

A PROFESSIONAL CORPORATION

Fee Proposal Breakdown for Reidsville High School - Machining Lab/Locker Room Renovation

October 12, 2018

	Hourly Rate	Manhours	Cost
Architectural	\$213.00	6	\$1,278.00
	\$141.00	80	\$11,280.00
	\$93.00	30	\$2,790.00
	Subtotal =	116	\$15,348.00
Structural	\$123.00	12	\$1,476.00
Mechanical	\$134.00	60	\$8,040.00
Electrical	\$134.00	40	\$5,360.00
Construction Administration	\$141.00	16	\$2,256.00
			\$30,224.00

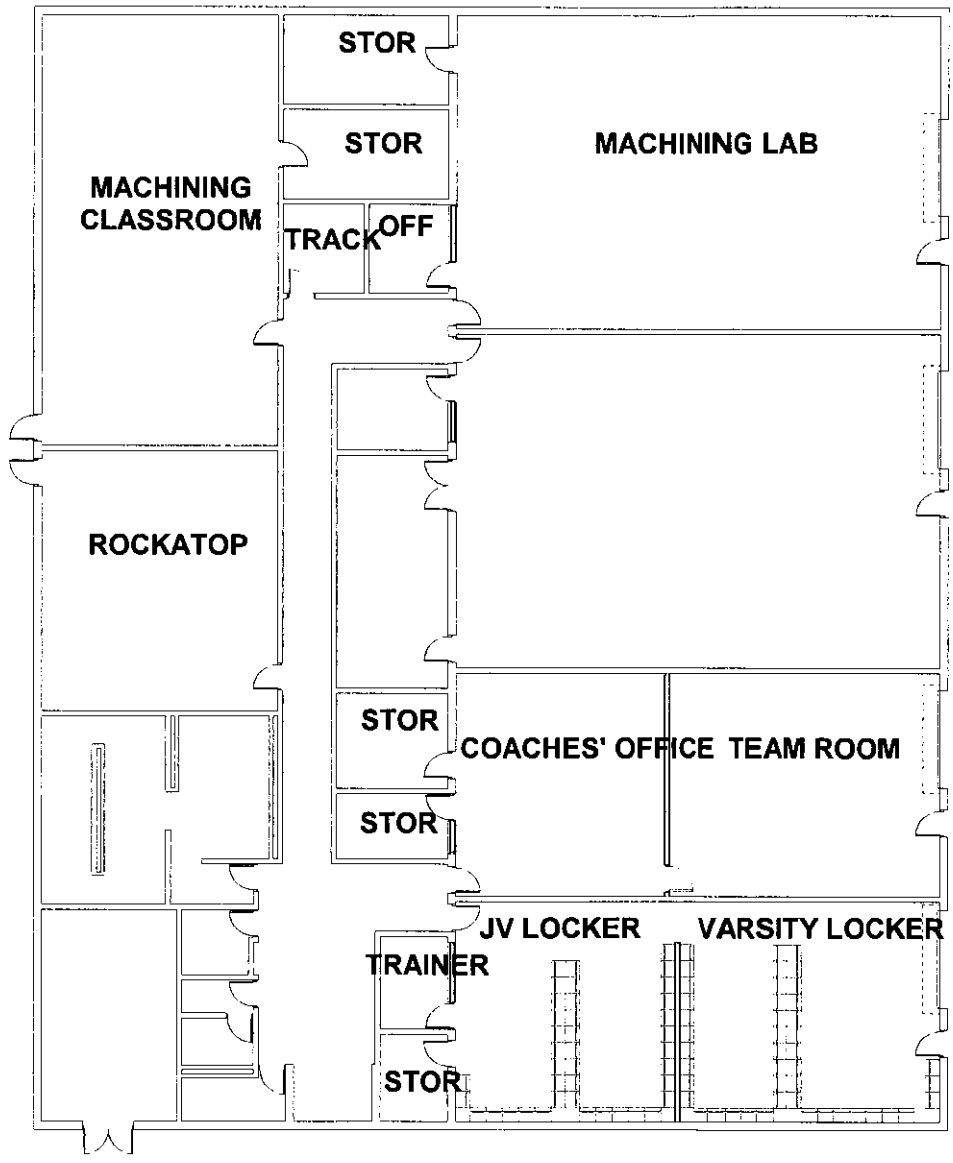

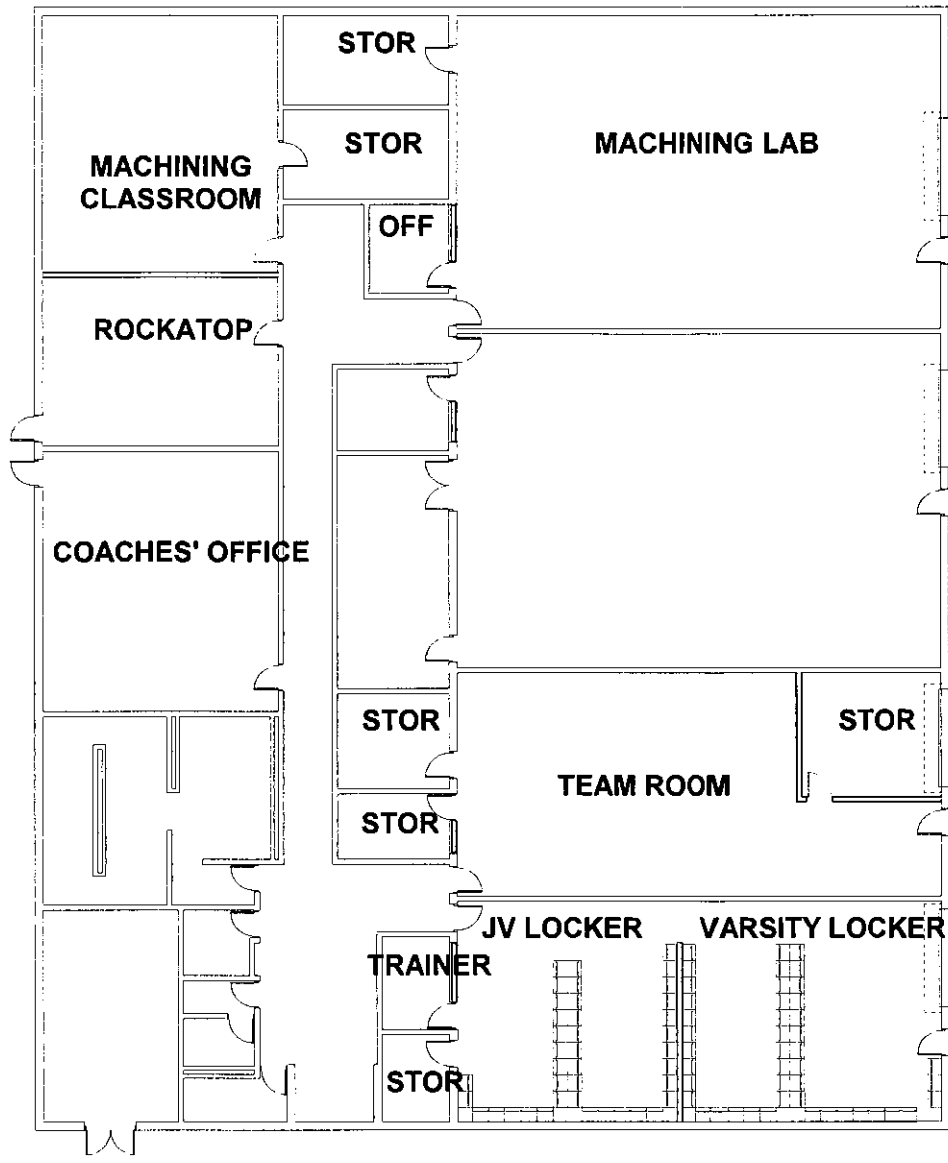

Reidsville HS Cost Estimate (Preliminary)

7/30/2018

	Amount	Unit		Factor	Unit		Total
OPTION 1							
8" Masonry Wall	280	SF		\$ 20.00	SF		\$ 5,600.00
6" CFMS W/ 2 side Gyp Wall	310	SF		\$ 6.00	SF		\$ 1,860.00
Wood Door / Steel Frame / Hardware	1	EA		\$ 2,000.00	SF		\$ 2,000.00
Locker Room Floor Paint / Sealant	1620	SF		\$ 1.75	SF		\$ 2,835.00
Locker Room Wall Paint	2650	SF		\$ 1.25	SF		\$ 3,312.50
Locker Room Ceiling	1620	SF		\$ 4.00	SF		\$ 6,480.00
Locker Room MEP Reconfiguration	1620	SF		\$ 5.00	SF		\$ 8,100.00
Coaches Offices (Combined) Floor Paint / Sealant	1650	SF		\$ 1.75	SF		\$ 2,887.50
Coaches Offices (Combined) Wall Paint	2700	SF		\$ 1.25	SF		\$ 3,375.00
Coaches Offices (Combined) Room Ceiling	1650	SF		\$ 4.00	SF		\$ 6,600.00
Coaches Offices (Combined) MEP Reconfiguration	1650	SF		\$ 5.00	SF		\$ 8,250.00
Office to Track Storage Conversion	1	LS		\$ 500.00	LS		\$ 500.00
Lockers	81	EA		\$ 500.00	EA		\$ 40,500.00
Conex Storage Unit	1	LS		\$ 5,000.00	LS		\$ 5,000.00
							\$ 97,300.00
Design Contingency	5%						\$ 4,865.00
						Construction Cost	\$ 102,165.00
OPTION 2							
8" Masonry Wall	280	SF		\$ 20.00	SF		\$ 5,600.00
6" CFMS W/ 2 side Gyp Wall	745	SF		\$ 6.00	SF		\$ 4,470.00
Wood Door / Steel Frame / Hardware	1	EA		\$ 2,000.00	SF		\$ 2,000.00
Wall Demo @ Art Office	1	LS		\$ 500.00	LS		\$ 500.00
Locker Room Floor Paint / Sealant	1620	SF		\$ 1.75	SF		\$ 2,835.00
Locker Room Wall Paint	2650	SF		\$ 1.25	SF		\$ 3,312.50
Locker Room Ceiling	1620	SF		\$ 4.00	SF		\$ 6,480.00
Locker Room MEP Reconfiguration	1620	SF		\$ 5.00	SF		\$ 8,100.00
Rockatop Floor Paint / Sealant	620	SF		\$ 1.75	SF		\$ 1,085.00
Rockatop Wall Paint	1250	SF		\$ 1.25	SF		\$ 1,562.50
Rockatop Ceiling	620	SF		\$ 4.00	SF		\$ 2,480.00
Rockatop MEP Reconfiguration	620	SF		\$ 5.00	SF		\$ 3,100.00
Machine Floor Paint / Sealant	920	SF		\$ 1.75	SF		\$ 1,610.00
Machine Wall Paint	1350	SF		\$ 1.25	SF		\$ 1,687.50
Machine Ceiling	920	SF		\$ 4.00	SF		\$ 3,680.00
Machine MEP Reconfiguration	920	SF		\$ 5.00	SF		\$ 4,600.00
Team Room/Sto Floor Paint / Sealant	1650	SF		\$ 1.75	SF		\$ 2,887.50
Team Room/Sto Wall Paint	2700	SF		\$ 1.25	SF		\$ 3,375.00
Team Room/Sto Ceiling	1650	SF		\$ 4.00	SF		\$ 6,600.00
Team Room/Sto MEP Reconfiguration	1650	SF		\$ 5.00	SF		\$ 8,250.00
Coaches Office Floor Paint / Sealant	925	SF		\$ 1.75	SF		\$ 1,618.75
Coaches Office Wall Paint	1470	SF		\$ 1.25	SF		\$ 1,837.50
Coaches Office Room Ceiling	925	SF		\$ 4.00	SF		\$ 3,700.00
Coaches Office MEP Reconfiguration	925	SF		\$ 5.00	SF		\$ 4,625.00
Cooridor Extension Floor Paint / Sealant	110	SF		\$ 1.75	SF		\$ 192.50
Cooridor Extension Wall Paint	390	SF		\$ 1.25	SF		\$ 487.50
Cooridor Extension Ceiling	110	SF		\$ 4.00	SF		\$ 440.00
Cooridor Extension MEP Reconfiguration	110	SF		\$ 5.00	SF		\$ 550.00
Lockers	81	EA		\$ 500.00	EA		\$ 40,500.00
							\$ 128,166.25
Design Contingency	5%						\$ 6,408.31
						Construction Cost	\$ 134,574.56